

Technical data

Pump name

DWO 300

Customer	Date 03-April-2018	Company
Contact	Item no. 1.1	Issued by
Phone	Project	Phone
E-mail	Project ID EBARA Pump Selector-2121165	E-mail

Requested data

1	Pump type	CENTRIFUGAL PUMPS	Fluid	Water, clean
2	Number of pumps / Reserve	1 / 0	Liquid temperature °C	20
3	Flow m³/h	0	Kin. viscosity mm²/s	1
4	Head m	0	Vapour pressure bar	0.022
5	Static head m	0	PH value	7
6	Inlet pressure bar	0.1	Density kg/dm³	1
7	Available system NPSH	0	Solids Weight %	0
8	Environmental temperature °C	20	Altitude m	1000

Pump

9	Pump name	DWO 300	Frequency Hz	50
10	Design	CENTRIFUGAL PUMPS	Installation type	STANDARD
11	Manufacturer	EPE	Impeller	Max. mm 107
12	Speed 1/min	2800	Diameter	Designed mm 107
13	No. of Stage	1		Min. mm 107
14	Connection Suction side		Flow	Operating m³/h
15	Connection Discharge side			Max- m³/h 57
16	Max Working Pressure bar	8		Min- m³/h 6
17	Shut-off head bar	1.51	Head	Operating m
18	Total weight kg	See the table of "Dimensions".		- (Qmax.) m 7.5
19	Shaft power kW			- (Qmin.) m 15.0
20			Max. Shaft Power at max. impeller	kW 2.16
21	Required NPSH m		Efficiency	%

Materials

22	Impeller	AISI 304		
23	Casing	AISI 304		
24	Shaft	AISI 304		
25				
26				
27				

Motor

28	Manufacturer	EPE Standard	Insulation class	F
29	Type	TEFC_DWO 300_400_Three Phase	Phases	3~
30	Specific design	IE3 / 50 Hz / Pole pairs 1	Frame size	
31	Rated power kW	2.2	Weight kg	0
32	Number of poles	2	Electric voltage V	400
33	Speed 1/min	2800	Electric current A	4.7
34	Degree of protection	IP 55		
35				

Remarks

Performance curve Pump name DWO 300

Customer	Date 03-April-2018	Company
Contact	Item no.	Issued by
Phone	Project	Phone
E-mail	Project ID EBARA Pump Selector-2121165	E-mail

Requested data

1	Flow	m³/h	0
2	Head	m	0
3	Static head	m	0

Pump

Operating Flow	m³/h	Frequency	Hz	50
Operating Head	m	Number of poles	2	
Impeller Diameter	Designed mm	Speed	1/min	

Test standard: ISO 9906:2012 - Grade3B

Water, clean [100%] ; 20°C; 0.9983kg/dm³; 1mm²/s

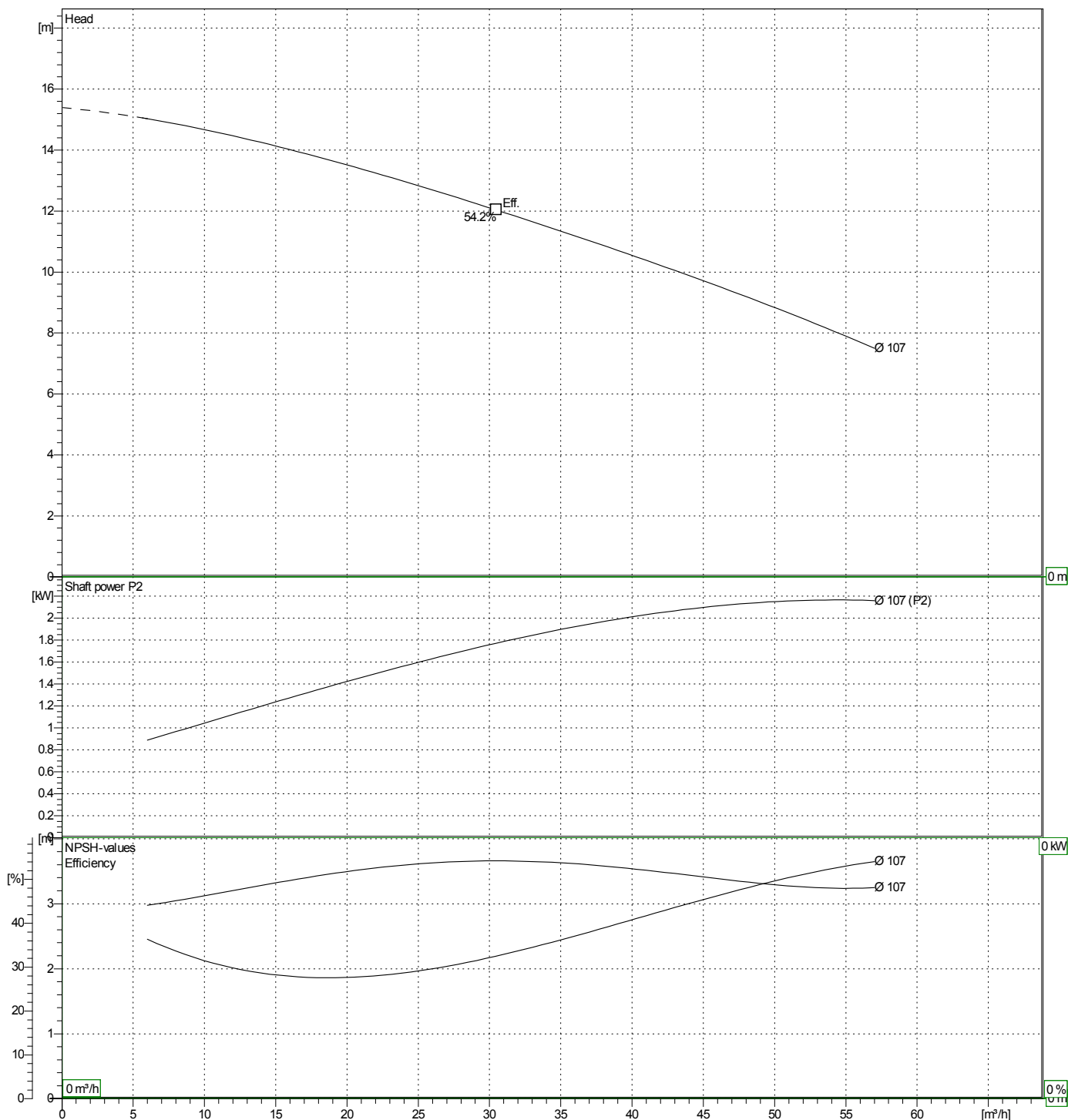

Dimensions

Pump name DWO 300

Customer	Date 03-April-2018	Company
Contact	Item no.	Issued by
Phone	Project	Phone
E-mail	Project ID EBARA Pump Selector-2121165	E-mail

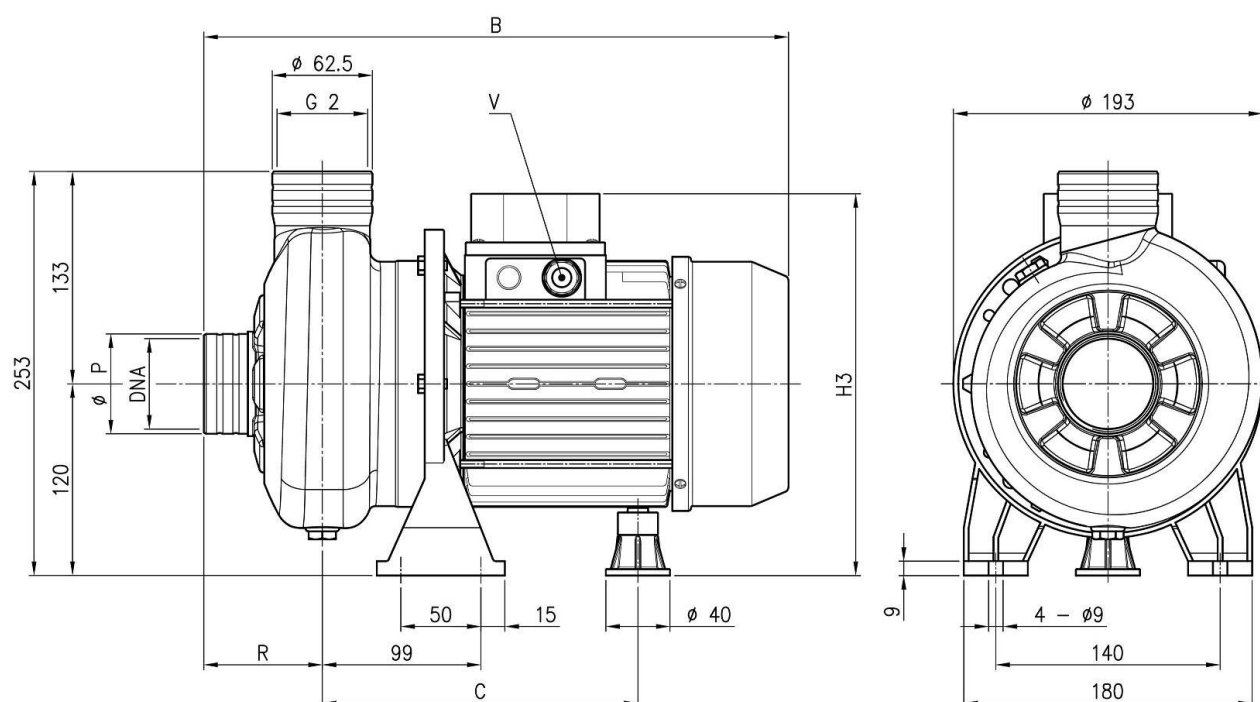

Dimensions in mm							
1	B	394.5					
2	C	197					
3	Dia P	80					
4	DNA	G 2 1/2					
5	R	78					
6	V	M20X1.5					
7	Weight P&M	19.4 kg					

(1/3) Construction

Pump name DWO 300

Customer	Date 03-April-2018	Company
Contact	Item no.	Issued by
Phone	Project	Phone
E-mail	Project ID EBARA Pump Selector-2121165	E-mail

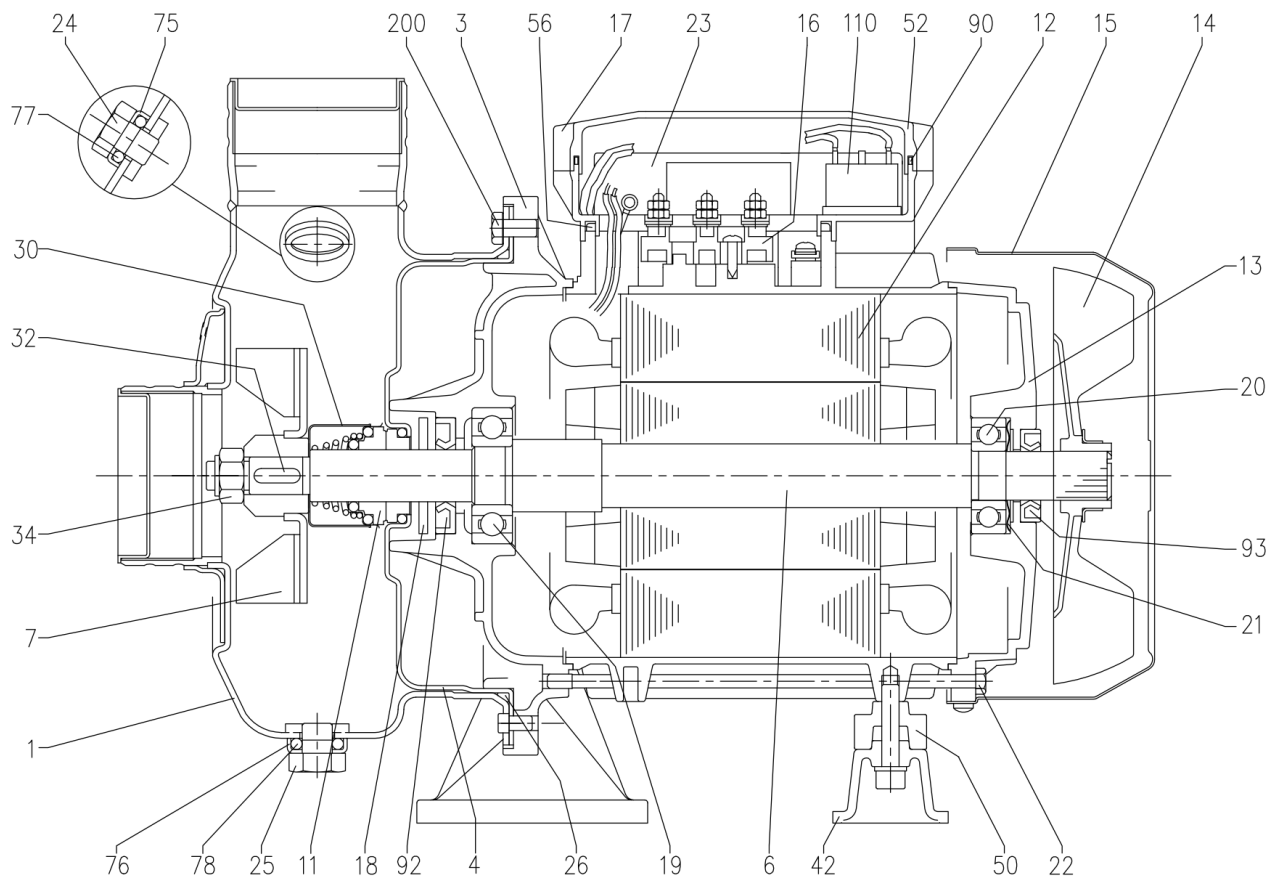

(2/3) Construction

Pump name DWO 300

Customer	Date 03-April-2018	Company
Contact	Item no.	Issued by
Phone	Project	Phone
E-mail	Project ID EBARA Pump Selector-2121165	E-mail

N°	PART NAME	MATERIAL	Q.TY
1	Casing	AISI 304	1
3	Motor bracket	Aluminium	1
4	Casing cover	AISI 304	1
6	Shaft with rotor	AISI 304 (Wet extention)	1
7	Impeller	AISI 304	1
11	Mechanical seal [3]	Carbon/Ceramic/NBR	1
12	Motor frame with stator	-	1
13	Motor cover	Aluminium	1
14	Fan	PP	1
15	Fan cover	Fe P04 Zincate	1
16	Terminal box	-	1
17	Terminal box cover [2]	Aluminium	1
18	Splash ring	NBR	1
19	Pump side ball bearing	-	1
20	Fan side ball bearing	-	1
21	Adjusting ring	Steel C70	1
22	Tie rod	Fe 420 Zincate	4
23	Capacitor [1]	-	1
24	Priming plug	AISI 303	1
25	Drain plug	AISI 303	1
26	O-ring [4]	NBR/FPM/EPDM	1
30	Mechanical seal protection	AISI 304	1
32	Key	AISI 316	1
34	Impeller nut	AISI 304	1
42	Motor support	Aluminium	1
50	Spacer	-	1
52	Terminal box [1]	PP	1
56	Box gasket	NBR	1
75	Washer	AISI 304	1
76	Washer	AISI 304	1
77	O-ring [4]	NBR/FPM/EPDM	1
78	O-ring [4]	NBR/FPM/EPDM	1
90	Terminal box cover gasket [1]	NBR	1
92	Lip seal	-	1
93	Lip seal	-	1
110	Protector [1]	-	1
200	Screw	Stainless steel A2 UNI7323	6

[1] Only for Single phase

[2] Only for Three phase

[3] See **CONSTRUCTION 3**

[4] FPM for H-HS-HW-HSW-Q1AVGG
EPDM for AQ1EGG-VAEGG-Q1U3EGG-U3BEGG
NBR only for Standard version

(3/3) Construction

Pump name DWO 300

Customer	Date 03-April-2018	Company
Contact	Item no.	Issued by
Phone	Project	Phone
E-mail	Project ID EBARA Pump Selector-2121165	E-mail

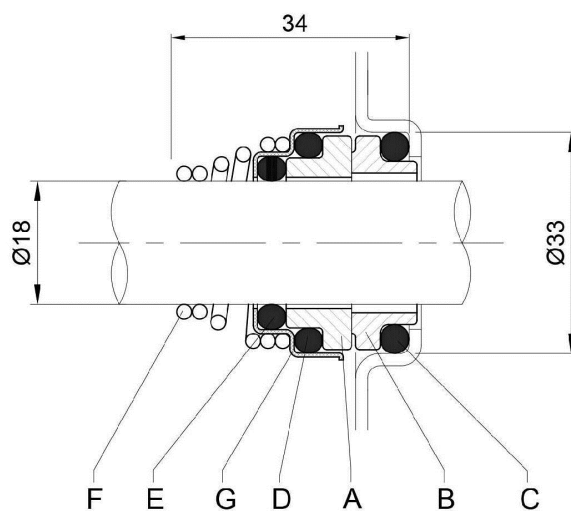

REF	PART NAME	MATERIAL Standard
A	Rotary seal ring	Ceramic
B	Stationary seal ring	Carbon graphite
C	O-ring	NBR
D	O-ring	NBR
E	O-ring	NBR
F	Self driving spring	AISI 316
G	Frame	AISI 304